

HAFCO-WOODMASTER

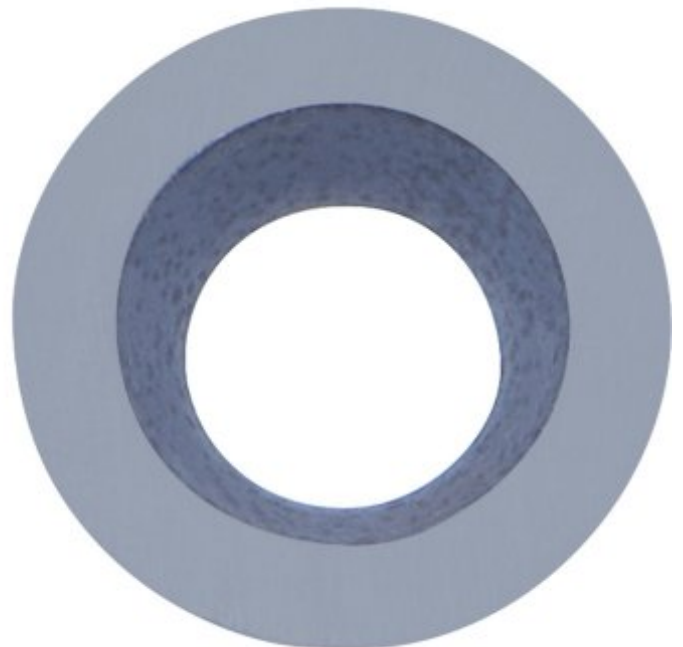

8.9mm - Round Carbide Insert

2 Piece Pack

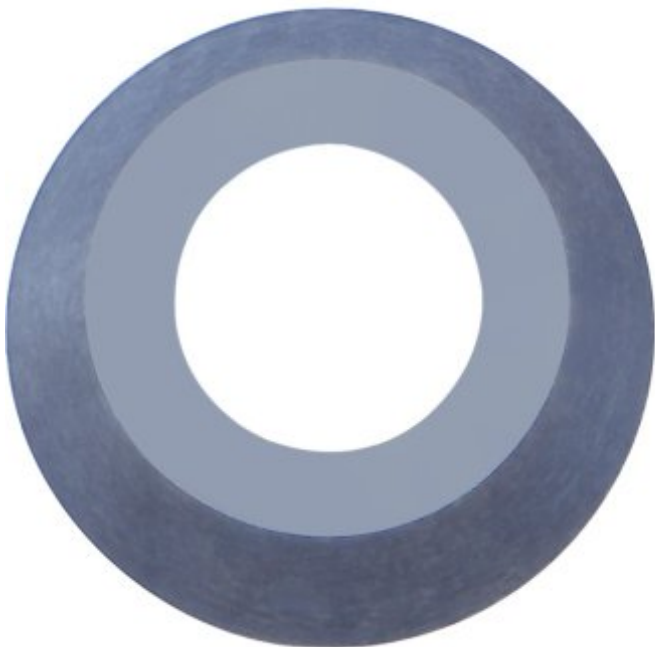

HAFCO-WOODMASTER 8.9mm - Round Carbide Insert

Low View

Description

Keep your carbide woodturning tools performing at their best with these replacement round tungsten carbide inserts. Designed to suit compatible carbide woodturning chisels, the round profile is ideal for smooth finishing cuts, gentle shaping, and producing clean surfaces on bowls, spindles, and other turned projects.

Manufactured from wear-resistant tungsten carbide for long service life, these inserts can be rotated to a fresh cutting edge when worn, reducing downtime and eliminating the need for sharpening.

Features

- Replacement round tungsten carbide insert
- Suits compatible carbide woodturning chisels
- Ideal for finishing, shaping and smooth contour work
- Long-lasting tungsten carbide cutting edge
- Rotatable design provides multiple usable cutting edges
- No sharpening required
- Supplied as a convenient 2-piece pack

Includes

- 2 Piece Pack

Specifications

HAFCO-WOODMASTER 8.9mm - Round Carbide Insert

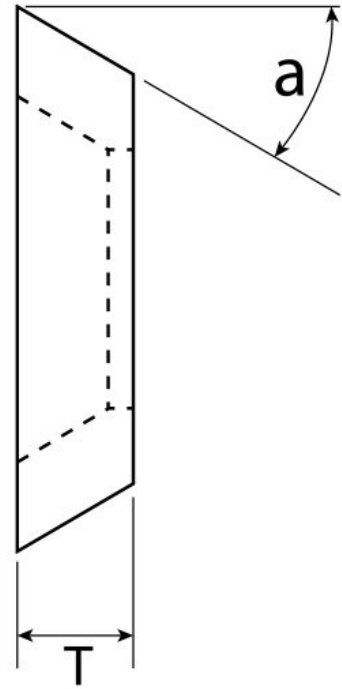
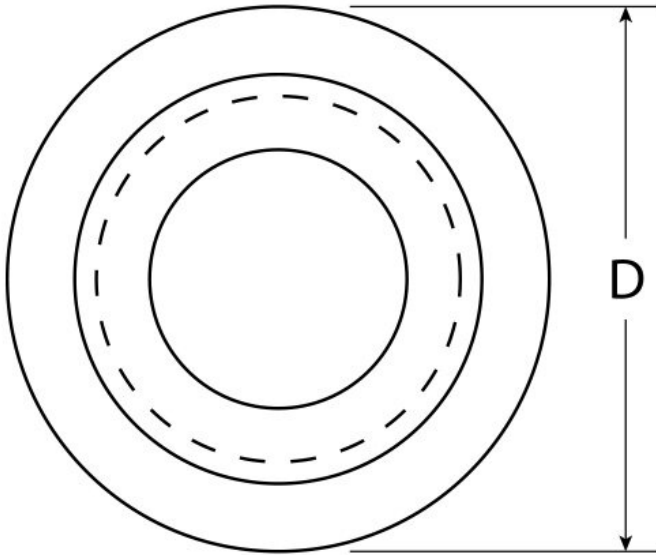

HAFCO-WOODMASTER 8.9mm - Round Carbide Insert

ORDER CODE

HAFCO-WOODMASTER 8.9mm - Round Carbide Insert

W30489

MODEL	~
Type	Round Carbide Insert
No. of Piece	2
Thread Size	~
D	8.9
L (mm)	~
W (mm)	~
T (mm)	1.85
a (deg)	30°
Suits	Wood Turning Tools - Insert Type