

VERTEX VA-8

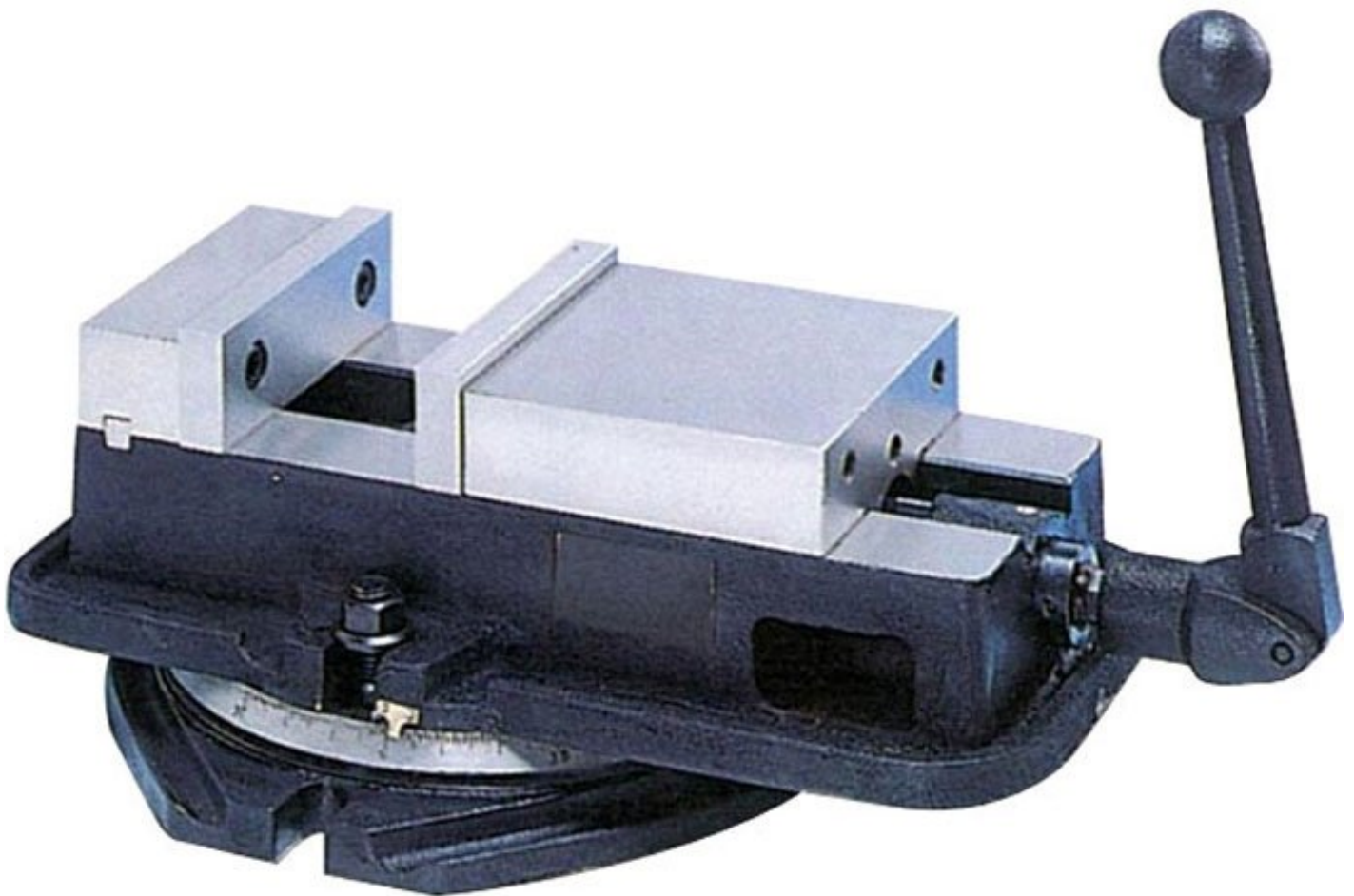

Vertex Anglock Machine Vice

203mm Jaw Width



VERTEX Vertex Anglock Machine Vice VA-8



Front View

Description

Ductile steel body with hardened and ground movable steel jaw.

Features

- All surfaces are precision ground and the bed is flame hardened
- Spherical segment allows for all directional alignment
- When clamping, a downward pressure of 1kg is exerted by the movable jaw for every 2kg of clamping pressure, preventing the work piece from tilting
- Bearing thrust collar cuts friction and increases clamping pressure
- Swivel base is graduated to 360°

Specifications

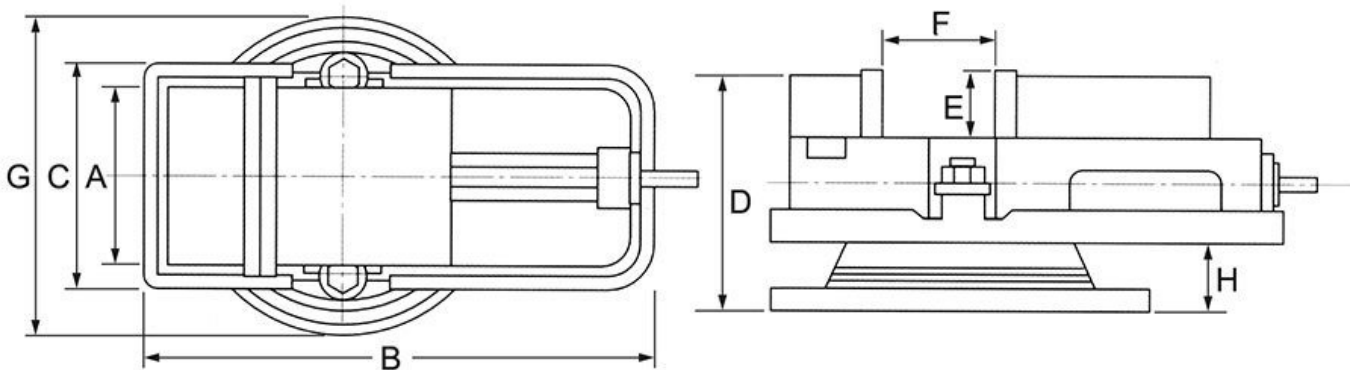

ORDER CODE	V307
MODEL	VA-8
A - Jaw Width (mm)	203
F - Jaw Opening (mm)	197
E - Jaw Depth (mm)	50
B (mm)	552

VERTEX Vertex Anglock Machine Vice VA-8

C (mm)	295
D (mm)	178
G (mm)	368
H (mm)	44
Nett Weight (kg)	97