

VERTEX VA-6

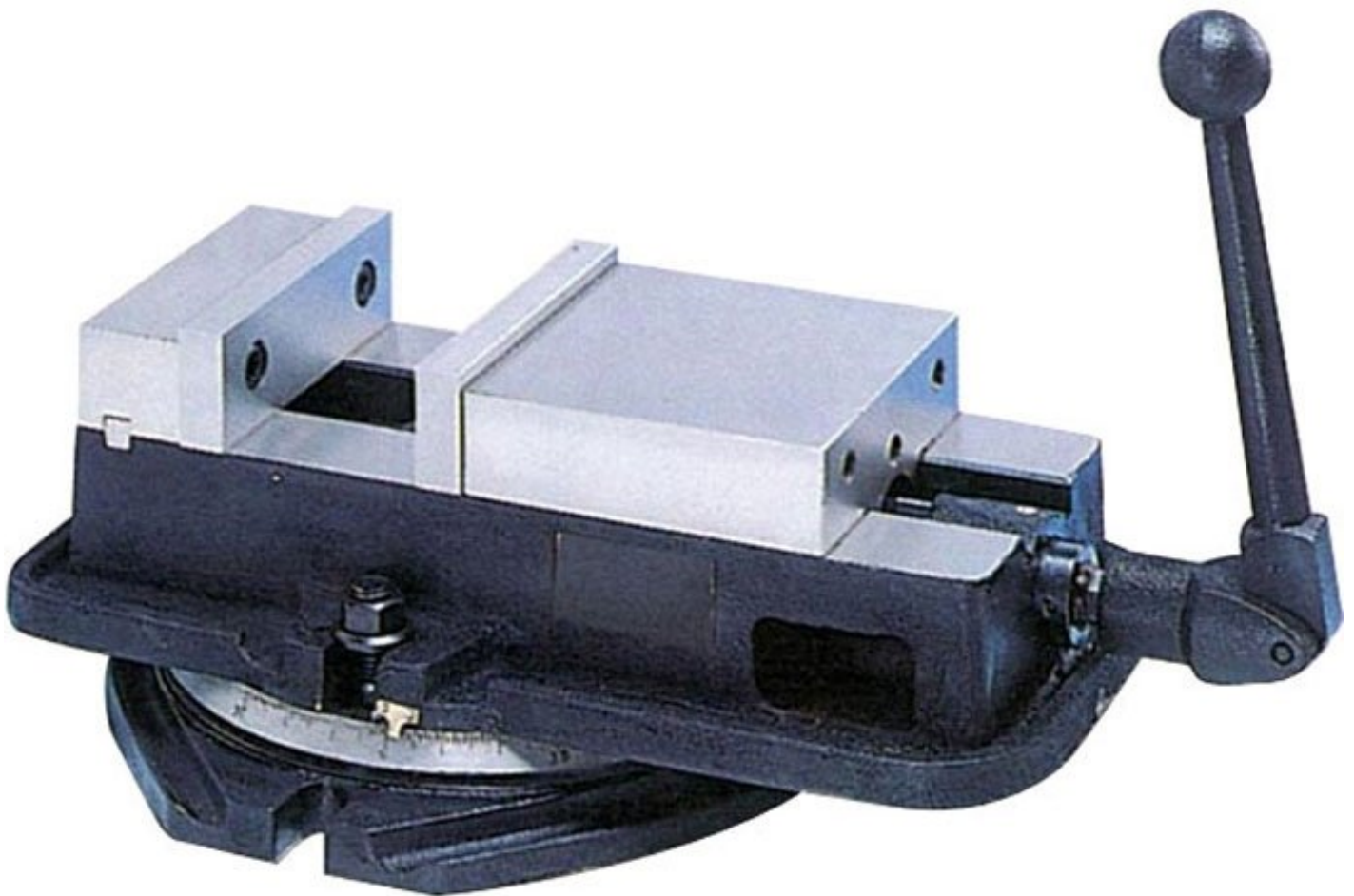

Vertex Anglock Machine Vice

152mm Jaw Width



VERTEX Vertex Anglock Machine Vice VA-6

Description

The VERTEX Anglock vice has a ductile steel body with hardened and ground movable steel jaw.

Features

- All surfaces are precision ground and the bed is flame hardened
- Spherical segment allows for all directional alignment
- When clamping, a downward pressure of 1kg is exerted by the movable jaw for every 2kg of clamping pressure, preventing the work piece from tilting
- Bearing thrust collar cuts friction and increases clamping pressure
- Swivel base is graduated to 360°

Specifications

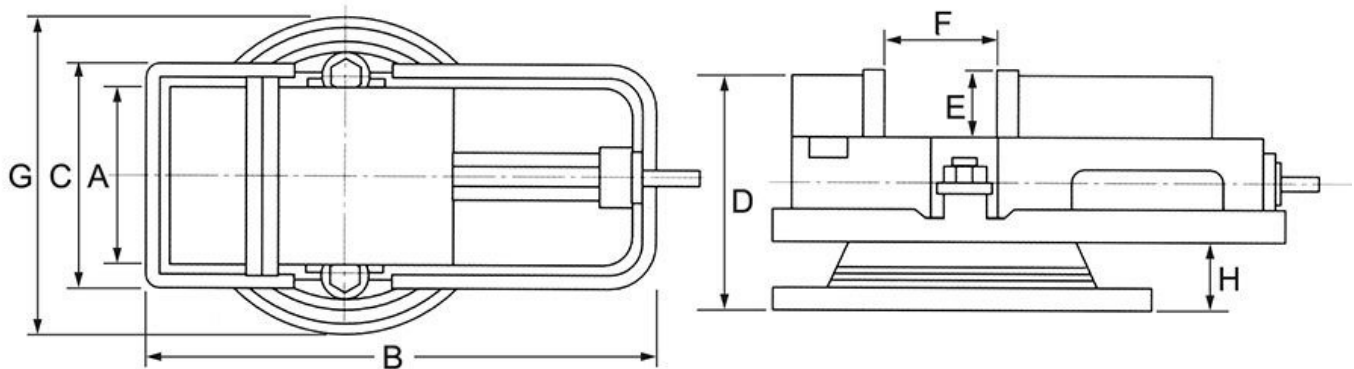

ORDER CODE	V306
MODEL	VA-6
A - Jaw Width (mm)	152
F - Jaw Opening (mm)	142
E - Jaw Depth (mm)	46
B (mm)	425
C (mm)	209
D (mm)	149
G (mm)	300
H (mm)	38
Nett Weight (kg)	45