

**TOOLMASTER**



**BT50-SLA40-120 Side Lock Holder (BT50)**

**Ø40mm**



**TOOLMASTER BT50-SLA40-120 Side Lock Holder (BT50)**

**Description**

Precision ground holder for use with 'Ripper' cutters and shank milling cutters where heavy milling is required

**Features**

- Precision ground
- Manufactured to MAS403BT50 standard
- M24 Pull Stud thread

**Specifications**

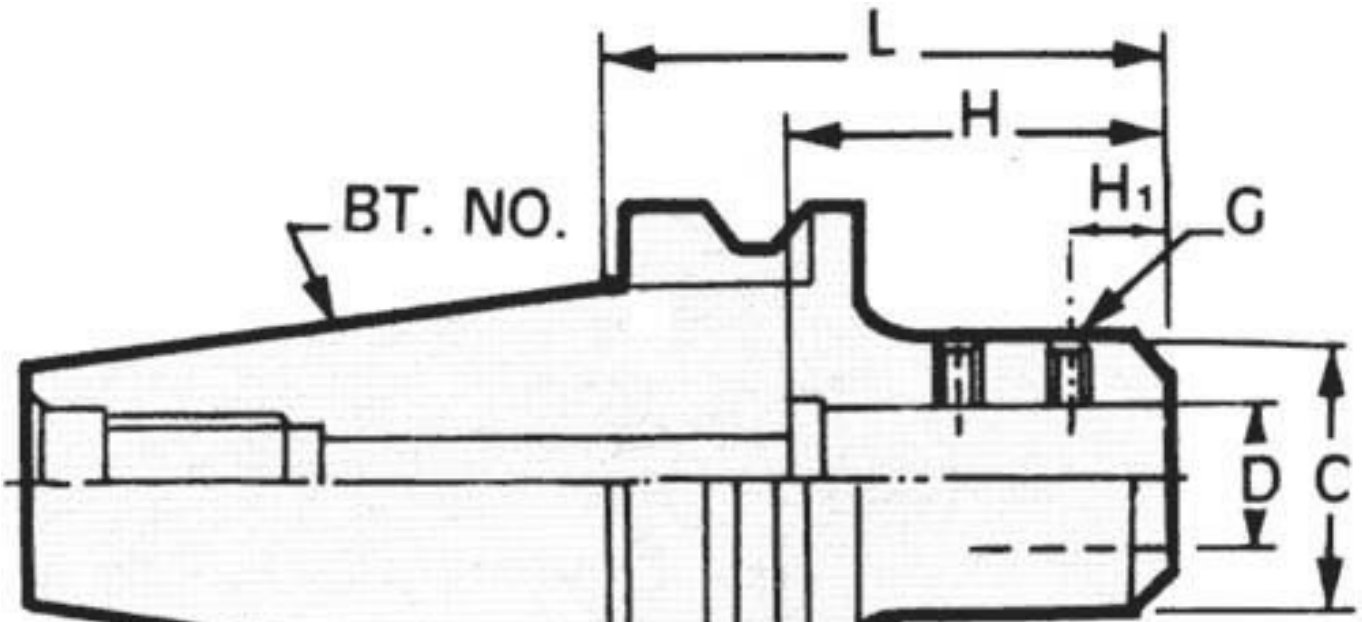

ORDER CODE	T468
MODEL	BT50-SLA40-120
Taper (BT)	BT50
D (mm)	40
C (mm)	90
H (mm)	90
L (mm)	120
H1 (mm)	30
G (mm)	M20
Nett Weight (kg)	6.5