



TOOLMASTER

BT50 x ER32-100 Collet Chuck

Ø3-Ø20mm Range



TOOLMASTER BT50 x ER32-100 Collet Chuck



Front Right View



Side View



Rear View

Description

All BT collet chucks meet the specifications of machine tool builders (DIN 2080 taper Shank Grade AT-3 - 85% taper contact)

Features

- Precision ground
- Manufactured to MAS403BT50 standard
- M24 Pull Stud thread
- 100mm extension from the gauge line
- Locking spanner not included

Specifications

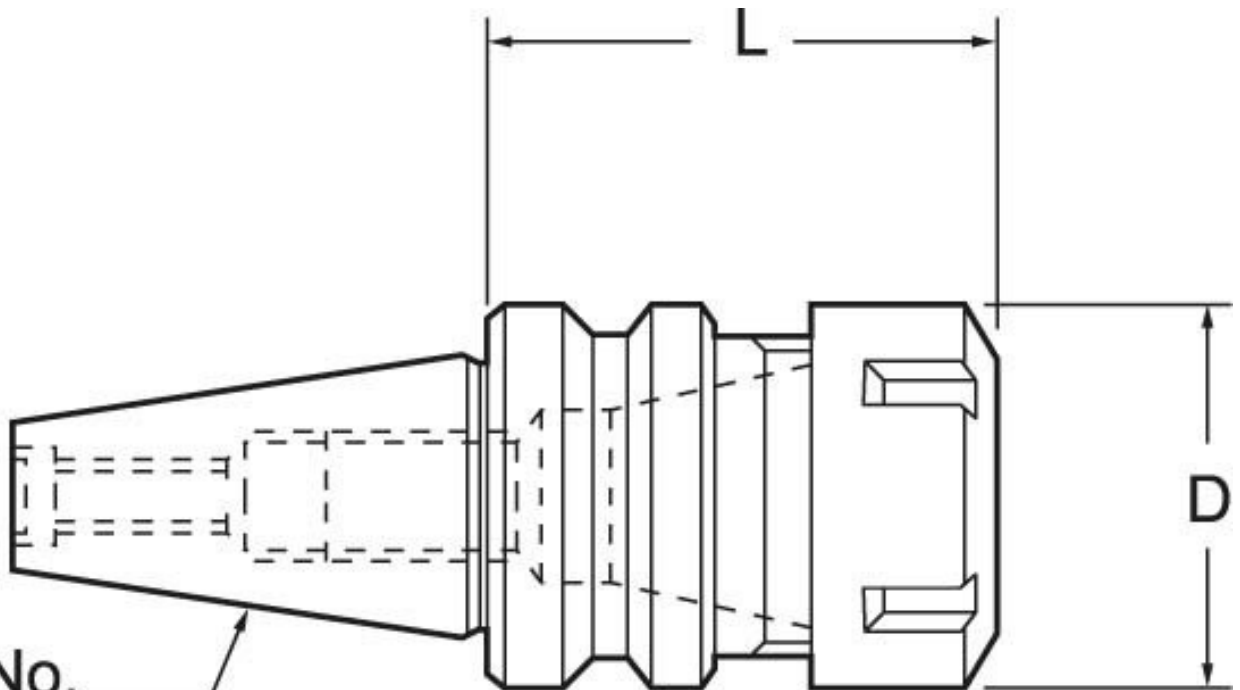

BT. No.

ORDER CODE

T448

MODEL

BT50 x ER32-100

Speed Rating (rpm)

10,000

Taper (BT)

BT50

TOOLMASTER BT50 x ER32-100 Collet Chuck

Capacity (mm)	3 - 20
L (mm)	100
D (mm)	50
Collet Type (ER)	ER32
Nett Weight (kg)	5.0