

**TOOLMASTER**



**BT50-ASC32-110 Collet Chuck Multilock (C SERIES)**

**Ø6-Ø32mm Range**



**TOOLMASTER BT50-ASC32-110 Collet Chuck Multilock (C SERIES)**

**Description**

Collet chuck meet the specifications of machine tool builders (DIN 2080 taper shank grade AT-3 - 85% taper contact)  
 Collet chucks are rated to 10,000 rpm. (balancing up to 15,000 - 25,000 available on request)

**Features**

- Heavy duty collet chuck designed for ripper cutters and heavy metal removal
- Four layers of roller bearings provide increased gripping force
- Run-out accuracy of 5 microns can be obtained 100mm out from chuck
- The design ensures a powerful clamping force, minimising vibration and distortion
- Spanner not included

**Specifications**

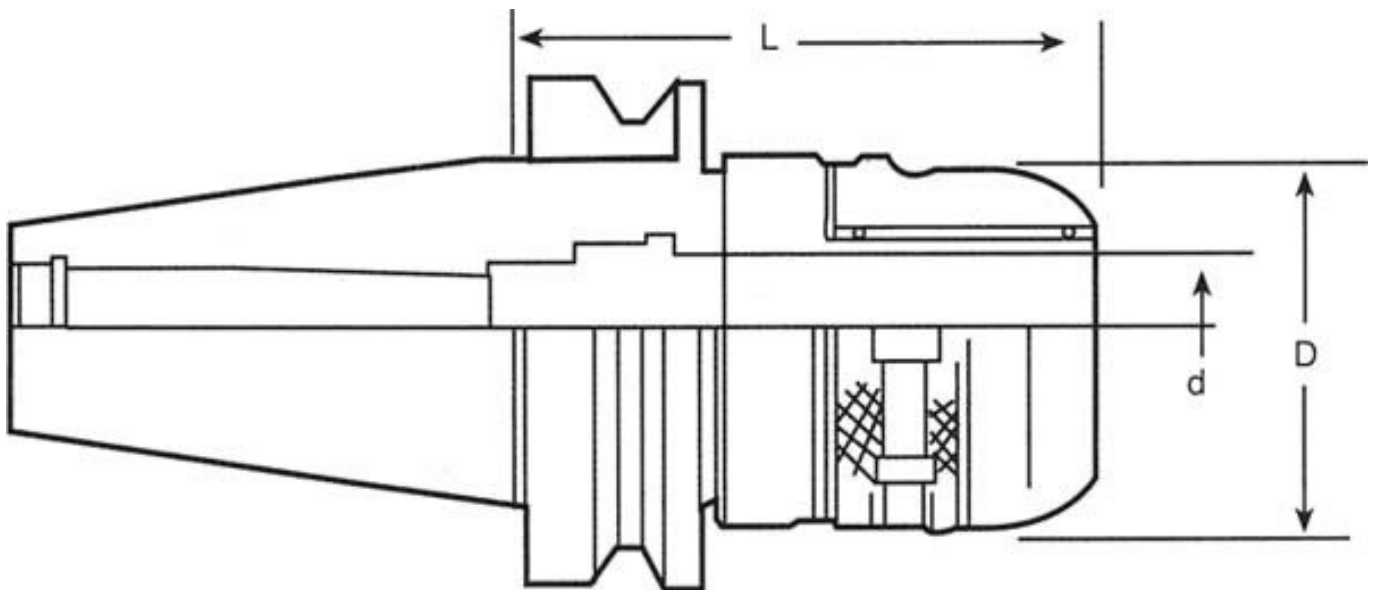

<b>ORDER CODE</b>	T302
<b>MODEL</b>	BT50-ASC32-110
<b>Taper (BT)</b>	BT50
<b>Capacity (mm)</b>	6 - 32
<b>d (lowercase) (mm)</b>	32
<b>D (mm)</b>	76
<b>L (mm)</b>	110
<b>Collet Type (SC)</b>	SC-32
<b>Nett Weight (kg)</b>	5.2