

TOOLMASTER TRT-8

Tilting Rotary Table

Ø200mm

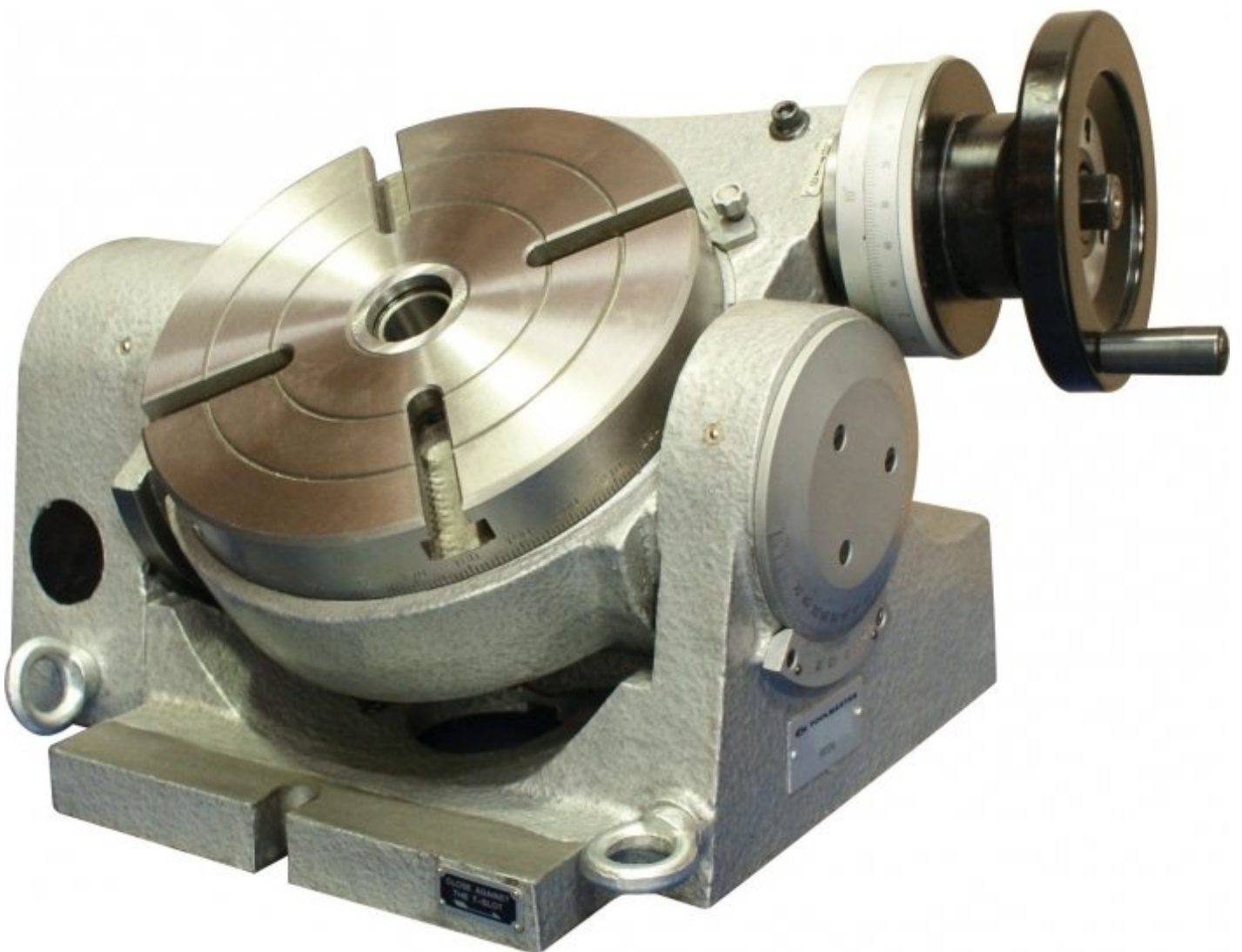

TOOLMASTER Tilting Rotary Table TRT-8

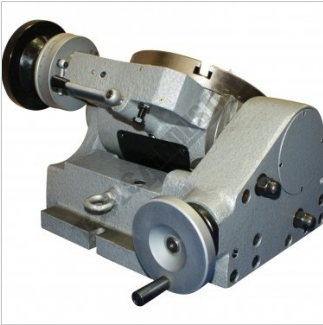

Rear View

Features

- An accurately designed rotary table for milling, boring and other machining operations
- The table allows for indexing, and other operations to be carried out rapidly with precision
- Low profile design minimises machine capacity losses without sacrificing work load capacity
- Tilting range from 0 - 90 degrees from the horizontal to vertical position and locked
- T-slots are machine to accept standard tee nuts
- One spindle rotation of the handle is equal to 3 degrees
- Accuracy of the tilting operation is 2 minutes
- 10 second vernier scale on table
- Table dial graduations 1 minute
- Worm ratio is 90:1
- Includes dividing plates

Specifications

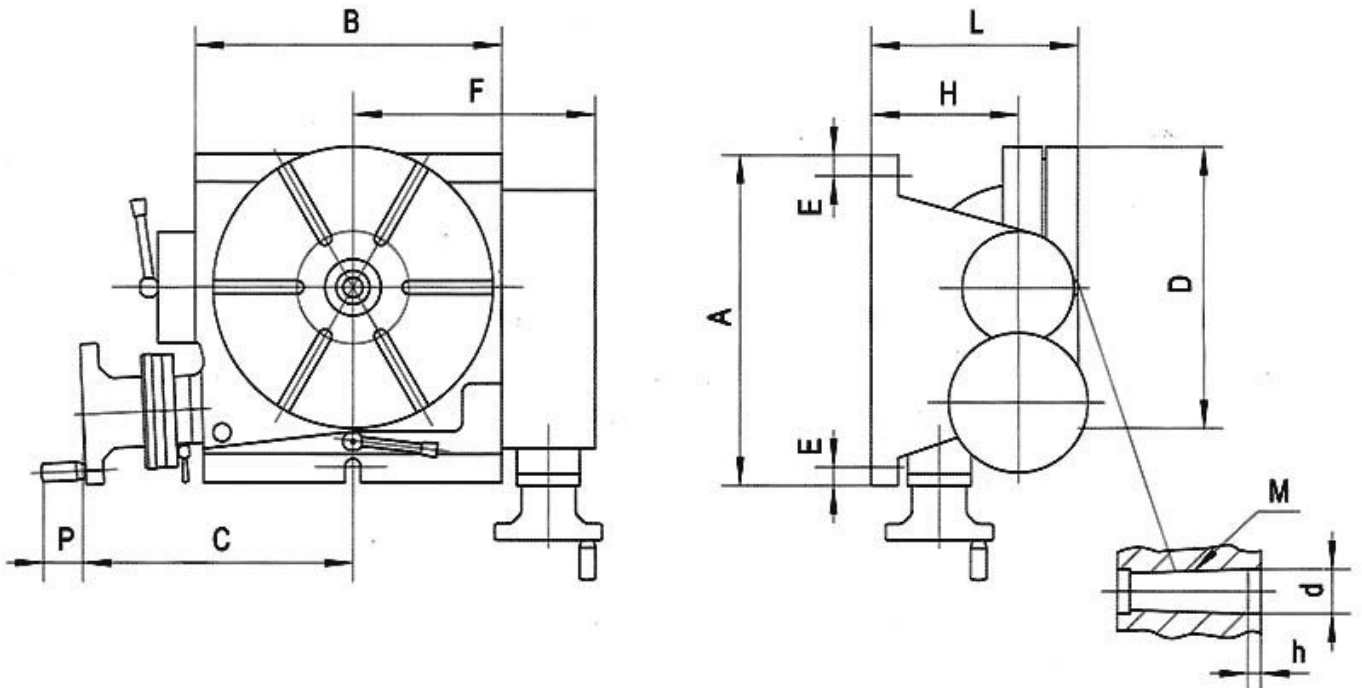

TOOLMASTER Tilting Rotary Table TRT-8

ORDER CODE

TOOLMASTER Tilting Rotary Table TRT-8

R026

MODEL	TRT-8
Size (mm)	200
A (mm)	296
B (mm)	213
C (mm)	186
D (mm)	Ø200
E (mm)	14
F (mm)	175.5
H (mm)	120
L (mm)	180
M (MT)	MT3
P (mm)	40
d (lowercase) (mm)	Ø30
h (lowercase) (mm)	6
T-Slot Size (mm)	12
Worm Ratio	90:1