

**TOOLMASTER BS-1A**

**Dividing Head - Semi Universal**

**128mm Centre Height**

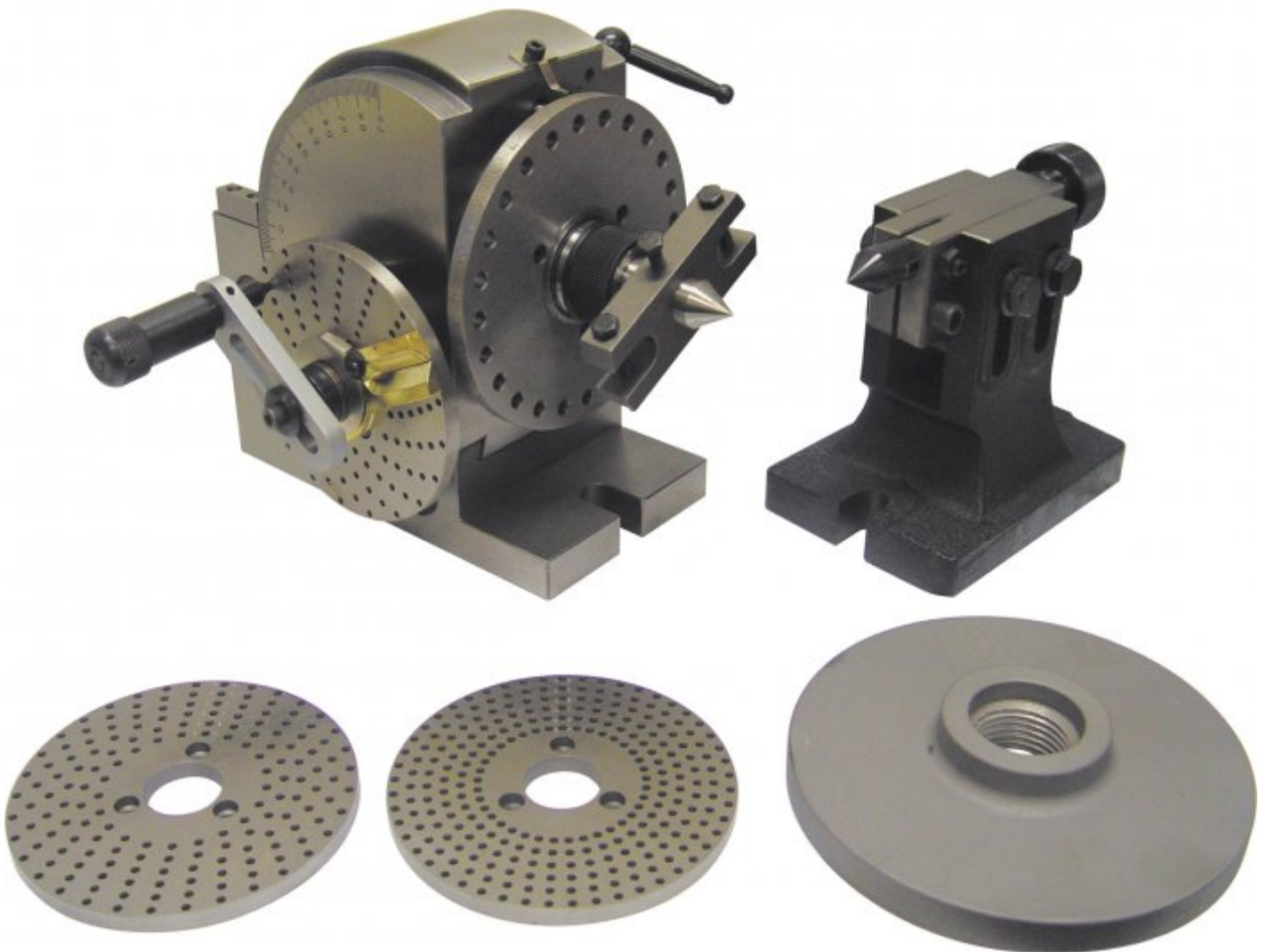

## TOOLMASTER Dividing Head - Semi Universal BS-1A

### Features

- Suitable for direct and indirect indexing
- Hardened and ground spindle rigidly held between taper roller bearings
- Threaded spindle nose for chuck mount
- Worm is hardened and ground with ratio between worm and worm wheel 40:1
- Direct indexing designed for quick divisions of No's 2, 3, 4, 6, 8, 12 & 24
- The head can be swivelled from 10° below horizontal to 90° vertical
- Designed to carry out all types of gear cutting, precision dividing
- Slotted base on dividing head & tailstock for use with key steel to align quickly on machine

### Includes

- Backing plate suits 160mm front mount 3 jaw chuck
- Dividing plates
- Tailstock
- Spindle thread 1-1/8" x 12TPI

### Specifications

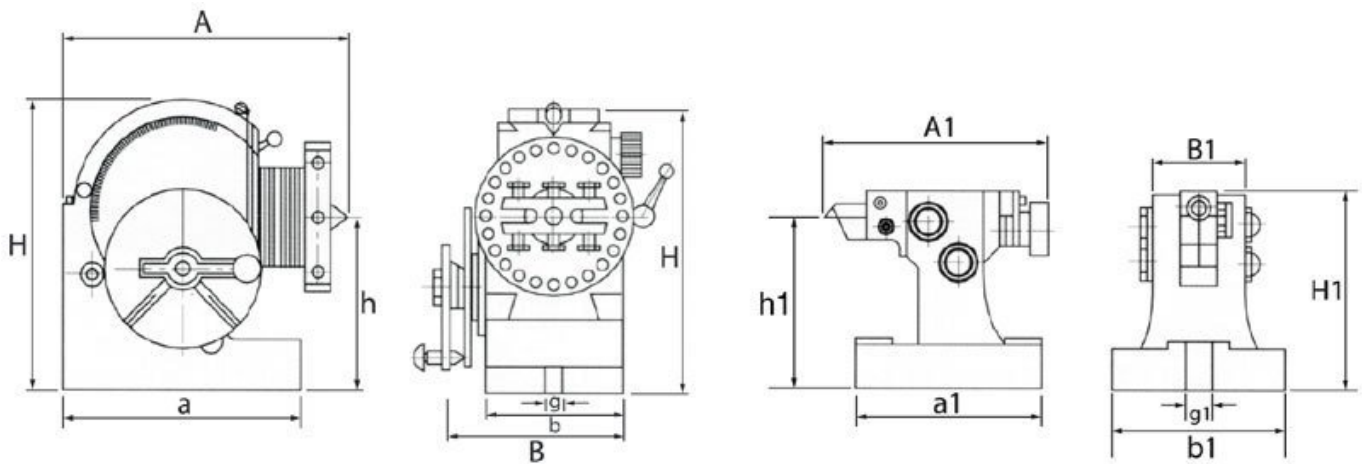

DIVIDING PLATES A, B, C				Number of Holes		
PLATE A	15	16	17	18	19	20
PLATE B	21	23	27	29	31	33
PLATE C	37	39	41	43	47	49

<b>ORDER CODE</b>	D0021
<b>MODEL</b>	BS-1A
<b>Taper (MT)</b>	MT3
<b>Bore (mm)</b>	20
<b>A (mm)</b>	293
<b>B (mm)</b>	156

## TOOLMASTER Dividing Head - Semi Universal BS-1A

H (mm)	220
h (mm)	128
a (mm)	207
b (mm)	114
g (mm)	16
A1 (mm)	191
B1 (mm)	88
H1 (mm)	137
h1 (mm)	128
a1 (mm)	150
b1 (mm)	108
g1 (mm)	16
Nett Weight (kg)	30