

TOOLMASTER



Collet Chuck - 25 x 70L x ER20 Straight

Ø2-Ø13mm Range



TOOLMASTER Collet Chuck - 25 x 70L x ER20 Straight

Description

Toolmaster Straight shanked ER collet chucks are suitable for applications such as turret work or can be used as an extension when a long reach is required
Note: Spanner not included

Features

- Precision ground
- Clamping flat
- No step or shoulder on collet chuck

Specifications

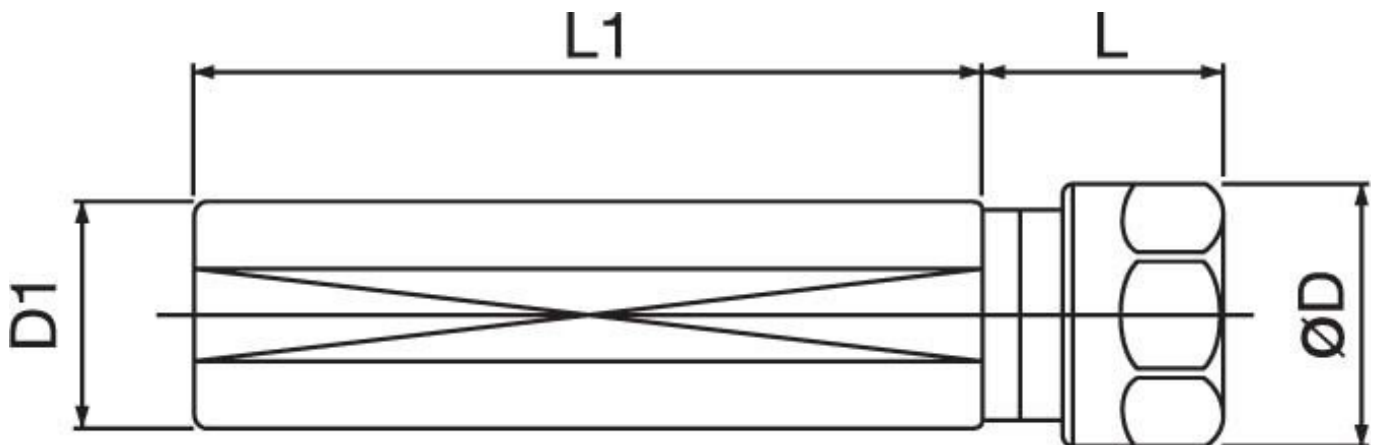

ORDER CODE	C854
MODEL	25 x 70L x ER20
Shoulder Type (Yes / No)	No
D (mm)	34
D1 (mm)	25
L (mm)	23
L1 (mm)	70
Nett Weight (kg)	0.3