



TOOLMASTER 3MT x ER16

Collet Chuck - 3MT x ER16

Ø1-Ø0mm



TOOLMASTER Collet Chuck - 3MT x ER16 3MT x ER16

Description

All ER collet chucks meet the specifications of machine tool builders (DIN 2080 taper Shank Grade AT-3 - 85% taper contact)
 Maintain a high level of accuracy.

Features

- Precision Ground
- Rated to 10,000rpm

Specifications

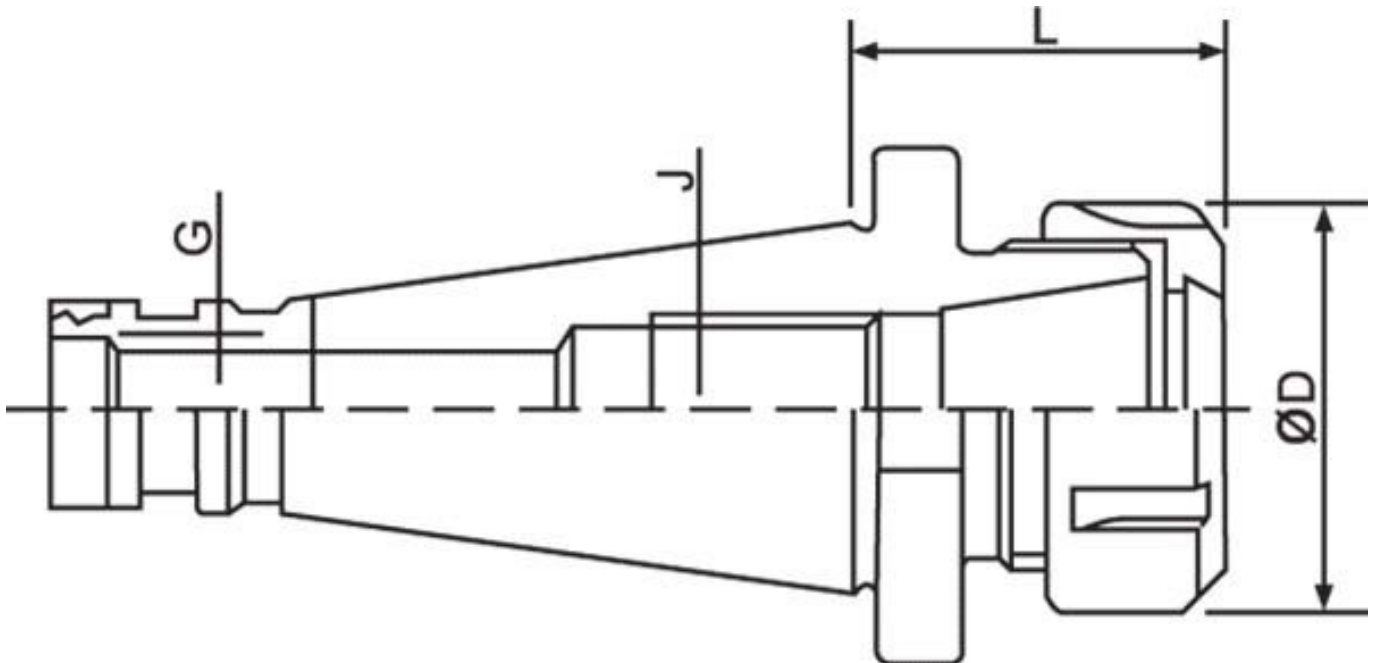

ORDER CODE	C104
Collet Type	ER16
Maximum Capacity (mm)	10
Taper (J)	3MT
Draw Bar (G)	1/2" Whitworth
L (mm)	40
ØD (mm)	28
Nett Weight (kg)	0.3